

HINGED DOUBLE REBATED DOOR MODEL HI-BDD-F79-2

A60 fire class
Tested to IMO 754(18)
FTP Code Part 3

EC Type-Examination Certified
CE Marked with the Wheel



STANDARD SPECIFICATION:

Doorleaf: 54 resp 44 mm thick, 1,0 - 2,0 mm galvanized steel skins, Fipro or Thermax insulation core, preparation for latch and automatic flush bolts, reinforced for overhead doorcloser on pull side.

Frame: 3 mm Z profile in galvanized steel, as standard welded to bulkhead.

Sill: Inverted U-profile as alt. 3 in stainless steel.

Hoseport hatch: On request.

Finish: Primed.

Hardware: 2 or 3 adjustable hinges, latch, lever handle, door closer, automatic flush bolts in non active door leaf and door selector/co-ordinator.

Max. size: 2300 x 2240 mm WxH c/o.

Weight: Doorleaf = 35 kg/m²
Doorleaf and frame = 45 kg/m²

Sound reduction: Standard version 38 dB Rw
Acoustic version 43 dB Rw

Single leaf door: Data sheet MAH3

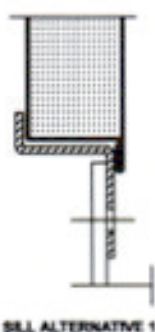
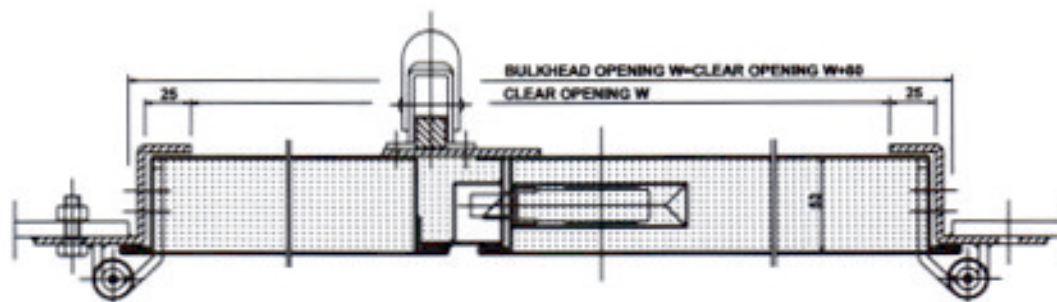
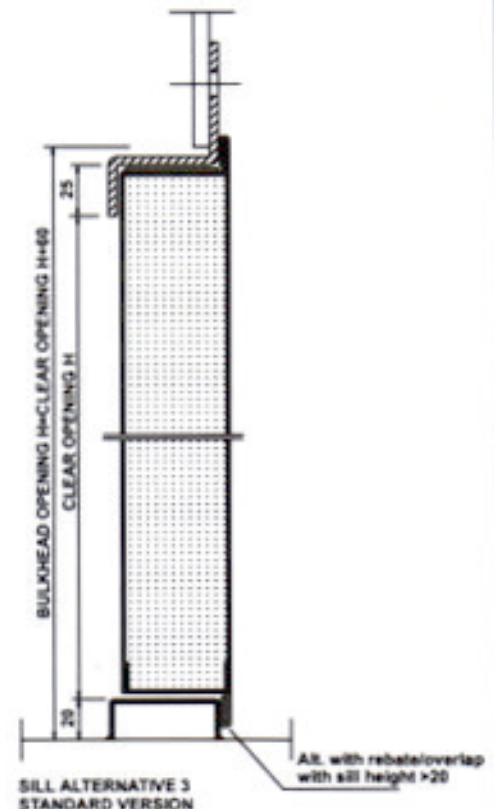

SILL ALTERNATIVE 1

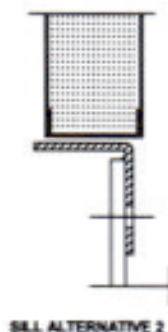

SILL ALTERNATIVE 2

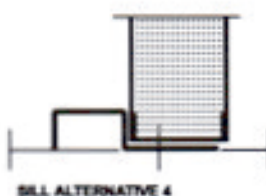

SILL ALTERNATIVE 4

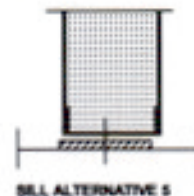

SILL ALTERNATIVE 5

SPECIAL FACTS

Optional features: Data sheet MOAH

All dimensions and measurements are subject to final check onboard and updated approval / production drawings